

Hisen Sampling Equipment



'HISEN'

SAMPLING EQUIPMENT



MP SERIES

MANUALLY OPERATED PLUG SAMPLER

- For process sampling of powders and granules, in non pressure applications.
- Sanitary design, demountable for cleaning access using triclover fittings.
- Construction: 316 S/S and FDA approved plastics.
- 38mm diameter plug.



AP SERIES

TEE HOUSING PLUG SAMPLER AIR OPERATED

- For process sampling of powders and granules in non pressure applications.
- Sanitary design, demountable for cleaning access using triclover fittings.
- Construction: 316 S/S and FDA approved plastics.
- Two models
- Festo air cylinder and control solenoid standard.
- Controller options available.
- Sample storage options available.
- Pressure application option available.

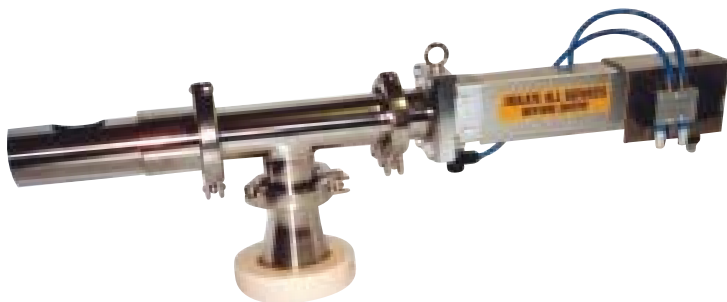

OPT SERIES

TEE HOUSING PLUG SAMPLER AIR OPERATED

- For process sampling of powders and granules.
- Sanitary design, demountable for cleaning access using triclover fittings.
- Construction: 316 S/S and FDA approved plastics.
- 50mm, 63mm, or 75mm plug sizes.
- Festo air cylinder and control solenoid standard.
- Pressure application option available.
- Sample storage option available.

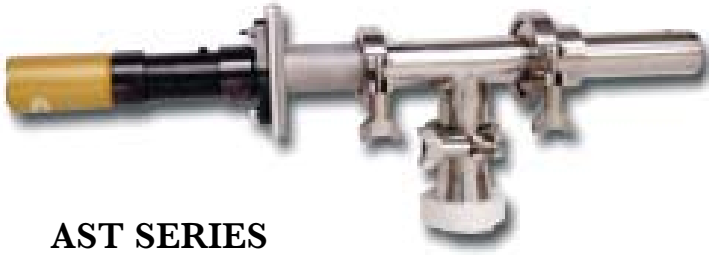

AST SERIES

Options: Pressure Control
Stand alone controller
Electric Motor Drive

AIR OPERATED SCREW SAMPLER

For process sampling of dairy, food and pharmaceutical powders.

- Non pressure application, hoppers, gravity chutes, bulk bag filling.
- Sanitary design, demountable configuration for cleaning access.
- Mounting ferrel supplied.
- Product contact parts- 316 stainless steel.
- Sample retained in plastic bag or optional reusable container.
- Air motor drive, Atlas Copco (dry vane).
- 316 Stainless Steel Auger



GG SERIES

AIR OPERATED GRAVITY SAMPLER

Applications: sampling grains, pellets, powders from gravity chutes or hoppers.

Construction includes:

- Fabricated and machined aluminium housing.
- Stainless steel probe 316 S/S.
- Teflon probe seals within the housing.
- 24 volt DC solenoid, air cylinder and air filter mounted and pre plumbed on the sampler.

Two Models: GG38 x 200
GG50 x 250

Options: Stand alone controller.
Sampler storage container/indexing cabinet.

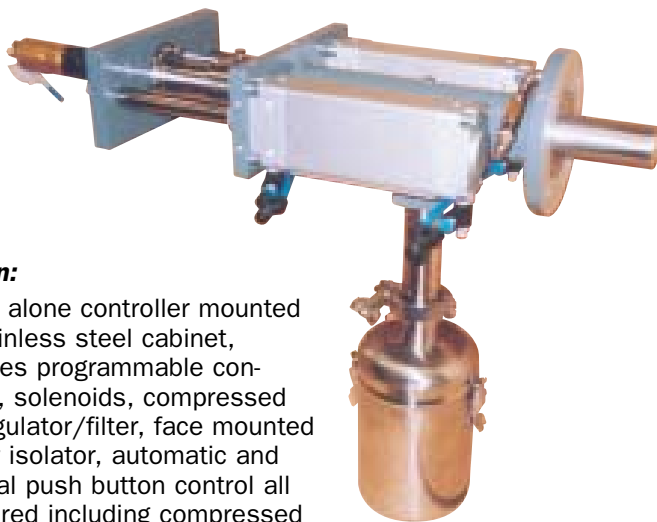

Option:

Stand alone controller mounted in stainless steel cabinet, includes programmable controller, solenoids, compressed air regulator/filter, face mounted power isolator, automatic and manual push button control all pre wired including compressed air connections pre plumbed.

SSP SERIES

PNEUMATIC CONVEYLINE SAMPLER

■ For sampling powder, granules, pellets or slurries without conveyline pressure influence on the sample collection container.

■ A close tolerance stainless steel auger within the probe, direct coupled to an air motor, discharges the sample from the probe following its retraction from the process stream.

Standard Construction:

- Fabricated and machined aluminium housing (316 stainless steel housing optional).
- 316 stainless steel sampling probe and screw auger machined from solid bar stock and polished.
- Housing seals, lantern rings and spacers > Teflon.
- Stainless steel discharge tube.
- Air cylinders FESTO.
- Air motor Atlas Copco (dry vane).

Three Models: SSP38-4
SSP38-6
SSP38-8

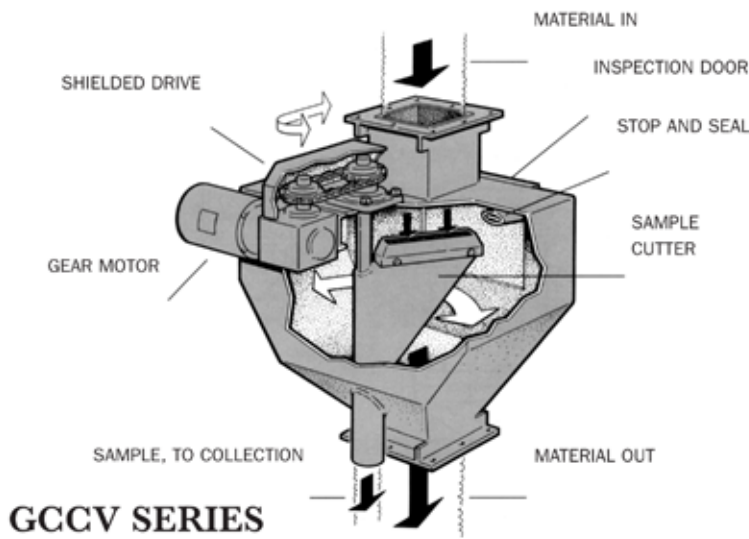

GRAVITY CROSS CUT sampler for vertical chutes.

- The sample cutter rotates through the product stream in a 120 degree arc collecting and diverting the sample into a container.
- Standard construction, mild steel. Stainless steel optional.
- Motor drive or air cylinder activated

AUTOMATED ROTATING INDEXING CABINET AND JAR COLLECTION

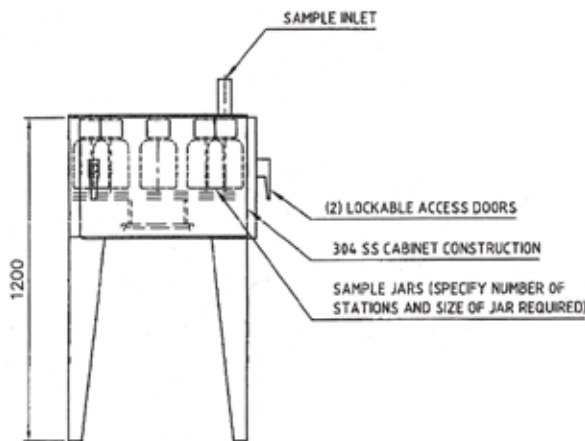

"A" DIMENSION

SAMPLE JAR	4	6	8	12
0.5 LITRE	460	460	460	670
1.0 LITRE	460	460	670	670
2.0 LITRE	460	670	670	670

No STATIONS

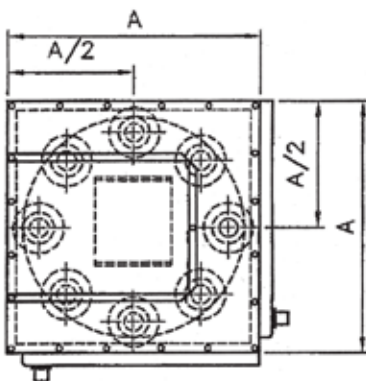

TWIN SAMPLE BAG HOLDER

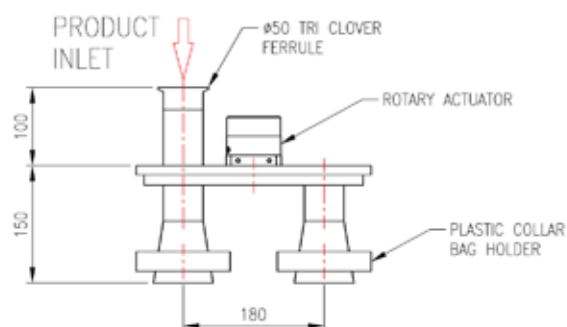

Process Engineering / GEA Colby

For any enquiries please contact Ron Purvis or Daniel Rodolico at:

ron.purvis@geagroup.com · daniel.rodolico@geagroup.com
 Unit 12 · 11 Mary Street · Blackburn · VIC 3130 · AUSTRALIA
 Tel: +61 3 9845 1200 · Fax: +61 3 9877 8188
 www.geacolby.com